



1/569 Great North Road Abbotsford NSW

2

Bright and modern with a clean professional ambience and level access, this well-presented ground floor office premises will appeal to a wide range of small businesses, health, beauty, property, financial services or design consultancies. One of three premises of this distinctive freestanding brick building on the corner of Great North Road and Spring Street, its a high exposure opportunity at the heart of Abbotsford Village. Next door to eateries, cafes and takeaways, its ideally located to service the local community with easy bus and road access from the Inner West, Chatswood and City. A great workplace location with plenty of staff, customer and client appeal.

+ Front & corner display windows & awning for high impact signage

Building Size : 72 sqm
View : <https://www.rogermickhail.com.au/7918215>



John Lagounaris
02 9713 5900

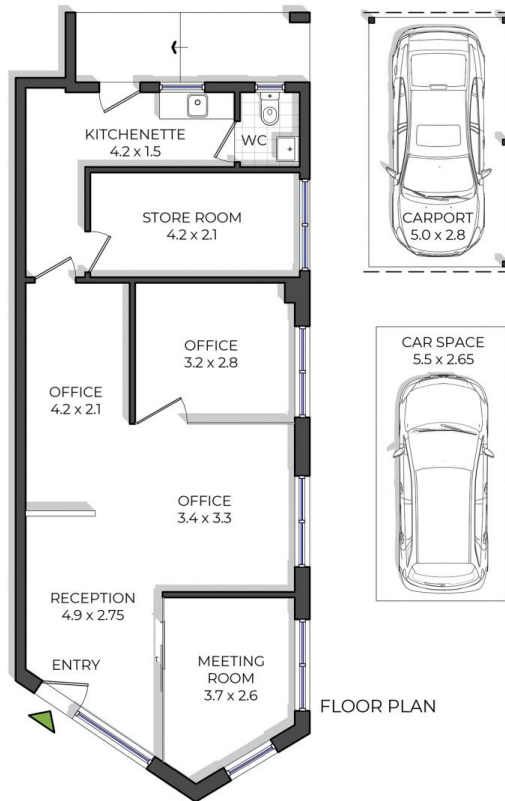

FLOOR PLAN



1/569 Great North Road, Abbotsford

The site plan and floor plan are not to scale. Measurements are indicative and in meters. Bushes and trees are placed for illustrative purposes. Plans should not be relied on. Interested parties should make and rely on their own enquiries.

roger m
mickhail

Internal area approx.: 72sqm
Parking area approx.: 29sqm
Total area on Title approx.: 101sqm